



**City of Biddeford
Traffic Committee**

June 30, 2026 at 6:00 PM
City Hall Council Chambers & Teams

[Join Teams Meeting Online](#)

Meeting ID: 255 206 826 458 678

Passcode: yQ7fV3B5

Or call in by phone: +1 872-242-8054

Phone conference ID: 956 702 406#

1. Call to Order
2. Staff Update
 - 2.a Update on parking issue located at 33 Round Hill Street.
 - 2.b Parkside Drive — Prohibited parking
3. Approval of Minutes
 - 3.a Approval of May 11, 2026, Traffic Committee meeting.
4. Discussion/Review
 - 4.a Pedestrian crossing intersection of Rt. 1 (Elm St) and Mason Street.
 - 4.b Moving Maine Network presentation by Kayla Lewis, Program Manager
 - 4.c City Engineer Craig Chekan to present two concept plans by the Department of Transportation regarding WIN284880.00 Biddeford Alfred St Sidewalk/Complete Streets plan.
5. Adjourn

City of Biddeford
Traffic Committee Meeting Minutes
Date May 11, 2026 at 6:00 PM
City Hall Council Chambers & Teams

1. Roll Call - The Committee was called to order at 6:00 PM by Councilor Cote, as chairperson.

ATTENDANCE

- Councilor Cote
- Councilor Woods
- Drew Guild
- Patrick Conlon
- JoAnne Fisk, Staff Liaison

Excused: Council President Beaupre, Councilor Doughty and Rick Doyon

2. Pledge of Allegiance

3. Adjustment(s) to Agenda – None

4. Approval of Minutes – March 31, 2026 meeting

Motion: Councilor Woods

Second: Drew Guild Vote: Unanimous

5. Discussion/Review –

- a. Scope of Committee work- Explore individually programs/projects such as Vision 0, Quick Build Demonstrations, Imagine People Here campaign. The committee understands the time required by staff and the ability to undertake each of these.
- b. Discussion on parking issue at 33 Round Hill Street to include property owner Colleen Doiron speaking to the committee. Chief to explore options for short term and long relief.
- c. Committee discussion on forwarding on to City Manager Traffic Engineering study by Sewall Engineering. Committee recommends Chief to discuss this with the City Manager for approval of funding options.
- d. Committee requests a meeting date set with Moving Maine Network regarding transportation needs in Biddeford.
- e. Brief on new parking ticket fine schedule under city ordinance 42.64.

Next Traffic Committee meeting date: June 23, 2026 at 6:00 P.M.

6. Motion to adjourn: Drew Guild Second: Councilor Woods

VOTE: Unanimous

Meeting adjourned at 7:13 P.M.



Traffic Committee

Meeting Date: June 30, 2026
Meeting Time: 6:00 PM
Agenda Item No: 4.a
Item Description: Pedestrian crossing intersection of Rt. 1 (Elm St) and Mason Street.
Submitted By: Chief JoAnne W. Fisk

Key Terms:

Executive Summary:

Crosswalk concern as reported by a citizen at the intersection of Rt. 1 and Mason Street.

Detailed Review:

Ward 5 resident has raised an issue with the lack of visibility at the crosswalk located at the intersection of Elm Street and Mason Street. Southbound moving traffic upon approaching the intersection are unable to visually locate the pedestrian crossing bars until they are in proximity to the crossing bars due to an incline just prior. The resident requests a review of the intersection for updated signage for both north and southbound vehicular traffic as well as moving the existing 35 mph speed sign south of the intersection.

Funding Source:

N/A

Staff Recommendation:

Staff should review the intersection for pedestrian movement changes.

Next Steps:

N/A

Attachments:

1. Intersection photos and map
2. Citizen correspondence



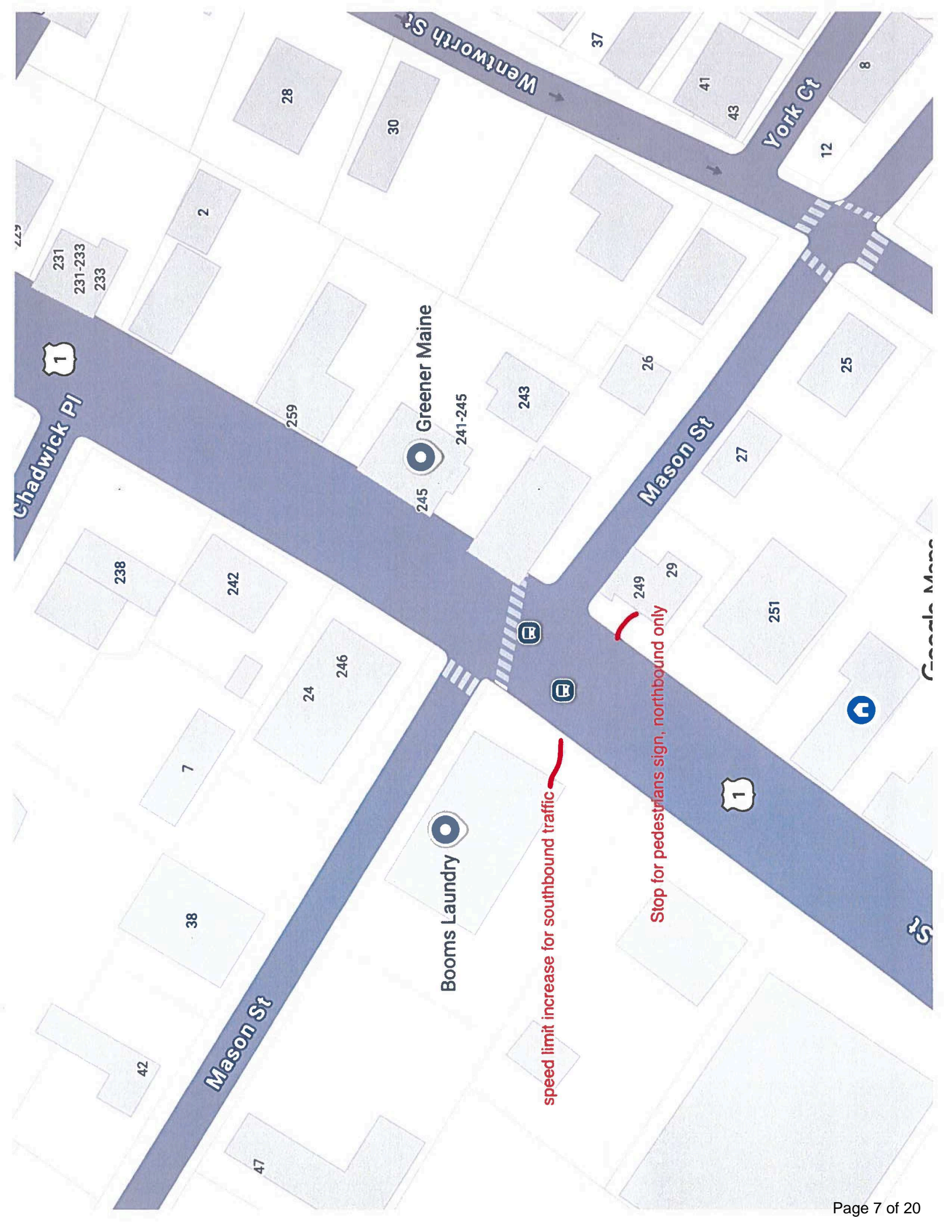

Greener Maine
241-245

Booms Laundry

speed limit increase for southbound traffic

Stop for pedestrians sign, northbound only





From: Cat Bates <cat@cat-bates.com>
Sent: Thursday, February 26, 2026 11:53 AM
To: Kurtz, David <david.kurtz@biddefordmaine.org>
Cc: Lessard, Marc <Marc.Lessard@Biddefordmaine.org>; Vadnais, Lisa <lisa.vadnais@biddefordmaine.org>; LaFountain, Liam <Liam.LaFountain@Biddefordmaine.org>
Subject: crosswalk concern

Caution: This is an external email. Please take care when clicking links or opening attachments. When in doubt, contact the IT Department

Hi David & others

It was good to see you at City hall Tuesday for the ward meeting. Thank you for requesting more details on my comment; here is a location-link for that crosswalk I mentioned: <https://maps.app.goo.gl/SMtZGLHoh51hw4ex9> - Elm st & Mason st

The crosswalk is at the crest of a hill. This means that south-bound traffic cant see it (even in the summer when the white bars arent mostly plowed away) until almost upon it, but they CAN see that the speed limit increases from 25 to 35. In my experience, this means much of south-bound traffic is accelerating as they approach it. There is NO crosswalk signage visible to south-bound traffic. North-bound there is a sign, but it is quite old. Pic attached, as well as a marked-up screenshot.

It feels relevant that there are bus stops on either side of the intersection, and a busy laundromat is located at the intersection as well. I suspect most of their customers drive, but I see many on foot.

I'm not savvy with the regulations around traffic/pedestrian signage, but to me safer would look like:
1. A cross-walk indicator sign for southbound & an updated sign for Northbound. 2. The 35mph sign moved back ~50'-100', so it becomes visible AFTER the crosswalk.

Thanks for considering this small but specific issue, and for representing ward 5 & Biddeford as a whole!

-Cat Bates
Ward 5 resident, 255 Elm st.



Traffic Committee

Meeting Date: June 30, 2026
Meeting Time: 6:00 PM
Agenda Item No: 4.b
Item Description: Moving Maine Network presentation by Kayla Lewis, Program Manager
Submitted By: Chief JoAnne W. Fisk

Key Terms:

Presentation on mobility needs for Biddeford residents.

Executive Summary:

Kayla Lewis, Program Manager for The Mobility Maine Network and Maureen Leary, Mobility Manager for York County Community Action Corp presenting information on the Network.

Detailed Review:

The presentation and following discussion will be centered around transportation issues in Biddeford. They are conducting a needs assessment as part of a new mobility management initiative in York County.

Funding Source:

N/A

Staff Recommendation:

N/A

Next Steps:

Informational presentation

Attachments:



Traffic Committee

Meeting June 30, 2026

Date:

Meeting 6:00 PM

Time:

Agenda 4.c

Item No:

Item City Engineer Craig Chekan to present two concept plans by the Department of
Description: Transportation regarding WIN284880.00 Biddeford Alfred St Sidewalk/Complete Streets plan.

Submitted

By: Craig Chekan, PE (City Engineer); Jeff Demers (Public Works Director)

Key Terms:

Executive Summary:

MaineDOT has submitted two concept alternatives for the City's Alfred Street Sidewalk Preliminary Design Report (PDR). Only one concept can be advanced for the PDR.

The Traffic Committee should recommend which concept alternative MaineDOT shall advance: Concept #1 (no bike lanes) or Concept #2 (bike lanes).

The selected concept will only be used for the Preliminary Design Report (PDR); final design and construction documents would occur in subsequent grant opportunities.

Detailed Review:

On 12/12/2022, Staff submitted a Complex Project grant application through PACTS/GPCOG to upgrade the sidewalks on Alfred Street (from Main Street to Washington Street) to mimic the Main Street streetscape design.

In early January 2023, the project was approved by PACTS for a Preliminary Design Report (PDR) through MaineDOT.

On 1/24/2023, City Council approved funding this Complex Project PDR; see attached Attest #2023.7.

On 5/6/2026, MaineDOT submitted two draft concept plans to Staff – seeking their preference:

- Concept Alternative #1 – contains no bike lanes
- Concept Alternative #2 – contains bike lanes

Staff met with PACTS and MaineDOT on 6/4/2026; the Traffic Committee was identified to select which alternative to advance for final concept design (due to impacts on existing parking).

Funding Source:

N/A

Staff Recommendation:

The Traffic Committee should select which Concept (Alternative #1 or #2) MaineDOT should utilize for their final Preliminary Design Report (PDR).

Next Steps:

MaineDOT to finalize preferred concept for their Preliminary Design Report (PDR) submittal.



MDOT will perform two Virtual Public Involvement (VPI) meetings in August and October (±).

Once the PDR submittal is finalized, the City will be eligible to apply for future grants for final design & implementation.

Attachments:

1. 1-Concept Alternative 1 - No Bike Lanes
2. 2-Concept Alternative 2 - Bike Lanes
3. 3-Evaluation Matrix
4. 4-Construction Cost Estimates
5. 5-Council Approval - 2023.7

SHADING LEGEND

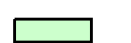
-  EXISTING PAVEMENT
-  PROPOSED 4.0" REINFORCED CONCRETE SIDEWALK
-  PROPOSED 4.0" LOAM AND SEED

STRIPING LEGEND

- SWL SOLID WHITE LINE (4")
- 2SYL TWO SOLID YELLOW LINES (4")
- WCH WHITE CROSS HATCHING (12")
- STOP BAR STOP BAR (24")

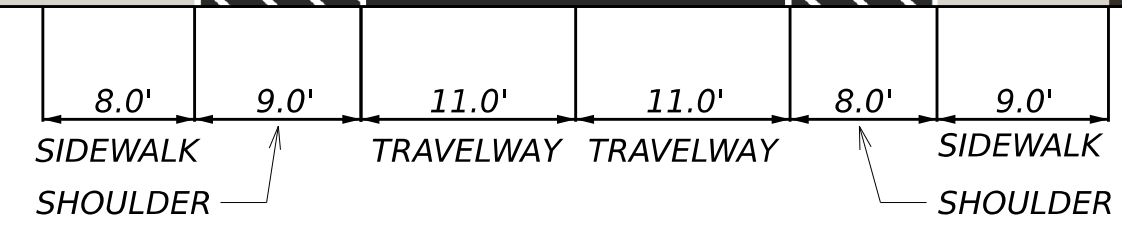
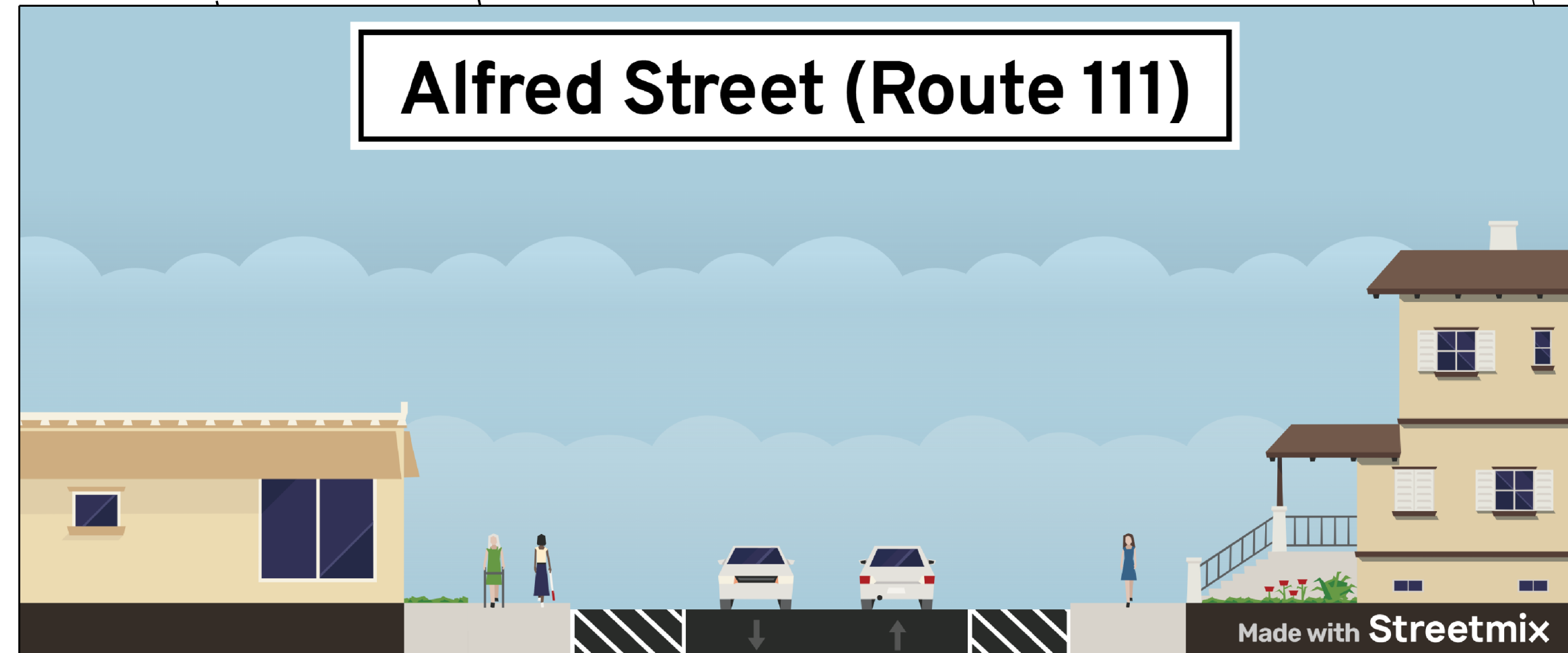
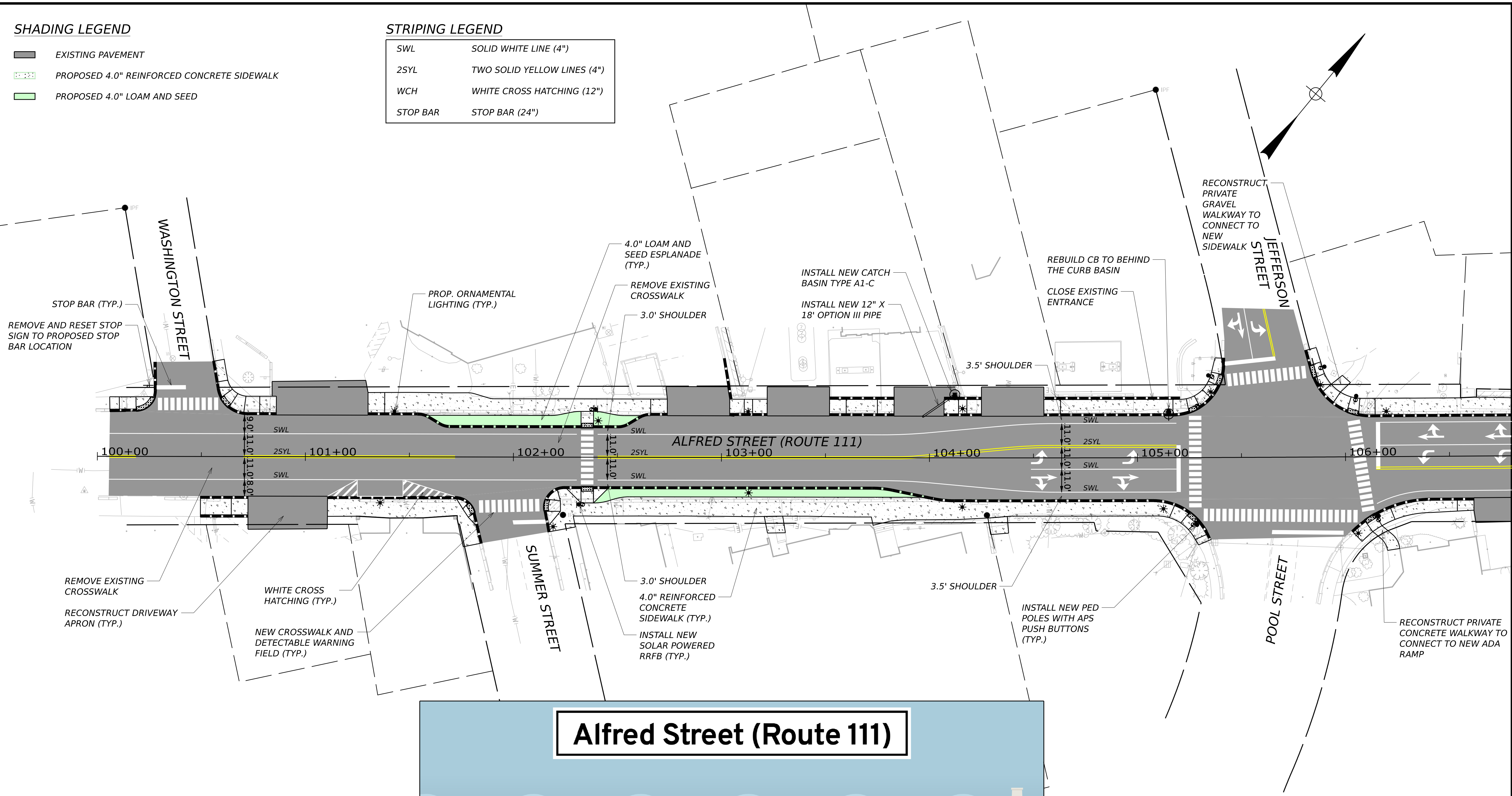

TYPICAL SECTION
STA. 100+75 TO 103+75

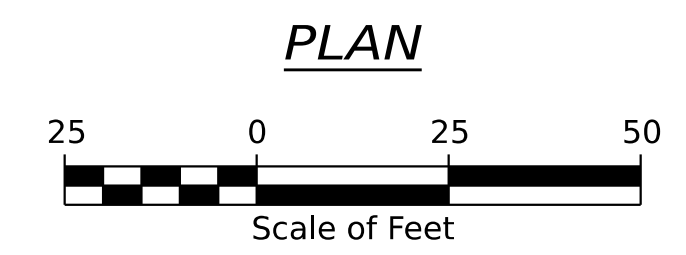

PLAN

STATE OF MAINE
DEPARTMENT OF TRANSPORTATION
28488.00
WIN
28488.00
HIGHWAY PLANS

| DATE | BY | DESCRIPTION | SIGNATURE | P.E. NUMBER | DATE |
|----------|-------------|------------------|-----------|-------------|------|
| 06/17/26 | J. STILWELL | PROJ. MANAGER | | | |
| 06/17/26 | Z. JACKSON | CHECKED-REVIEWED | | | |
| 06/17/26 | B. LYON | DESIGN-REVIEWED | | | |
| | | DESIGN-REVIEWED | | | |
| | | DESIGN-REVIEWED | | | |
| | | REVISIONS 1 | | | |
| | | REVISIONS 2 | | | |
| | | REVISIONS 3 | | | |
| | | REVISIONS 4 | | | |
| | | FIELD CHANGES | | | |

BIDDEFORD
ALFRED STREET (ROUTE 111)
ALTERNATIVE 1

SHEET NUMBER
1
OF 2

Date: 6/18/2026

Username:

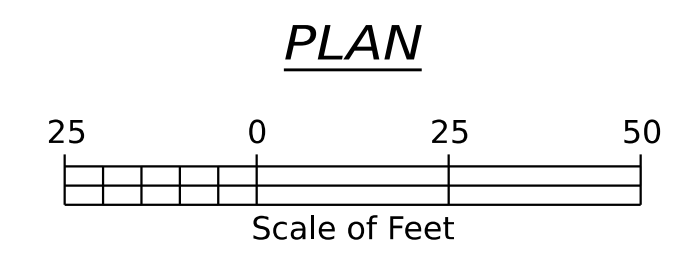
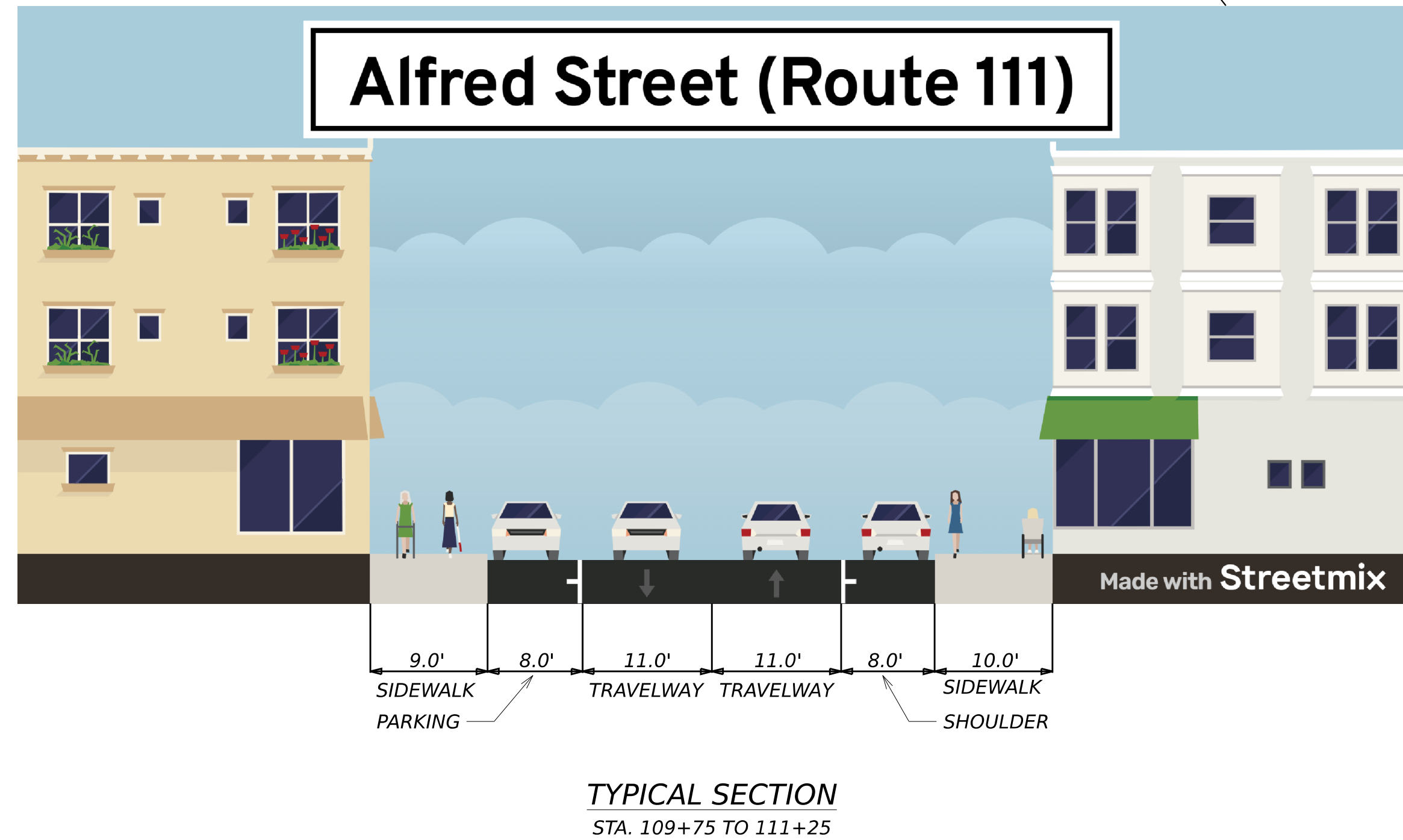
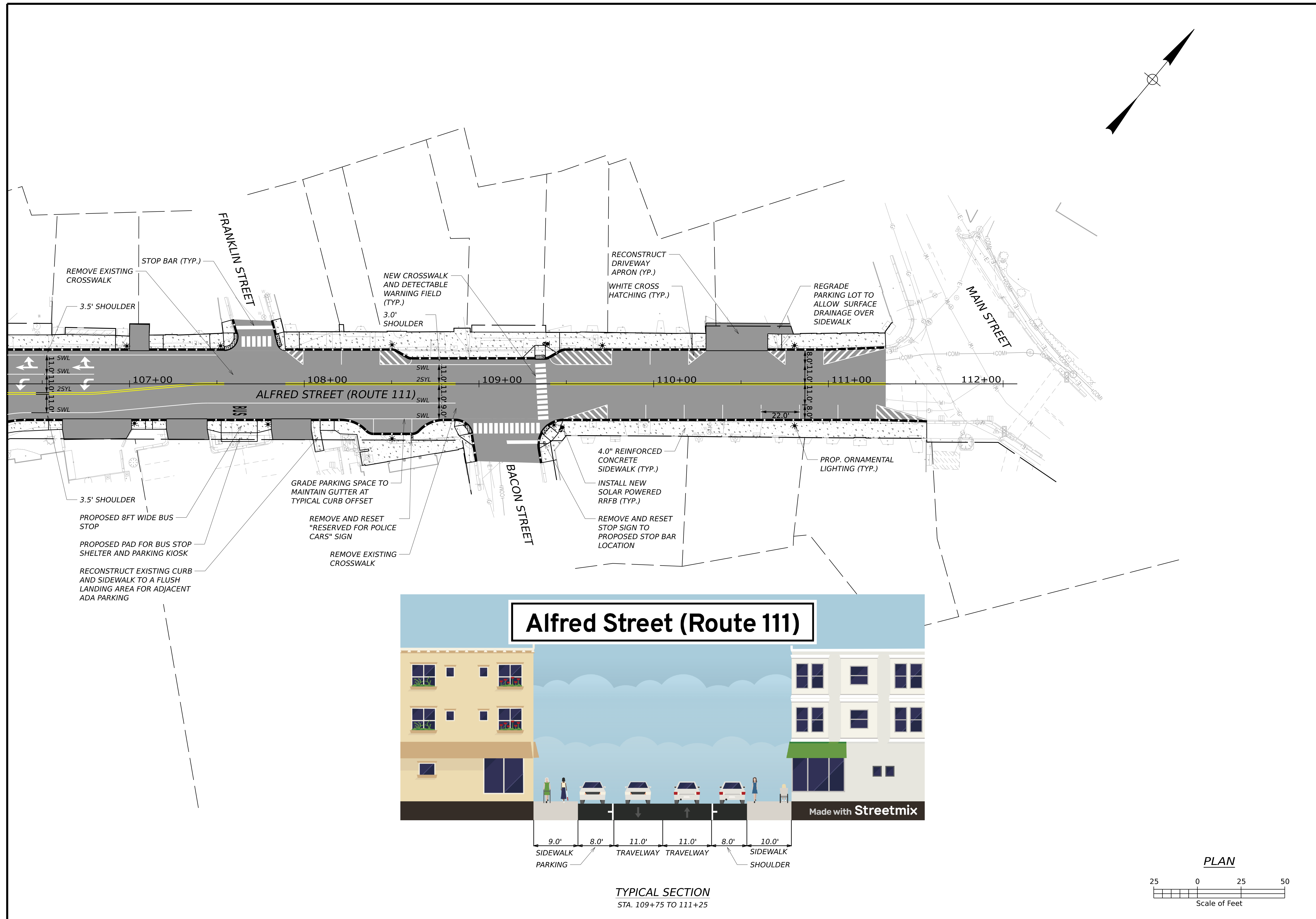

STATE OF MAINE
DEPARTMENT OF TRANSPORTATION

28488.00
WIN
28488.00
HIGHWAY PLANS

| PROJ. MANAGER | DATE | BY | SIGNATURE | P.E. NUMBER | DATE |
|------------------|----------|------------|-----------|-------------|------|
| J. STILLWELL | 06/17/26 | Z. JACKSON | | | |
| DESIGN-REVIEWED | 06/17/26 | B. LYON | | | |
| CHECKED-REVIEWED | | | | | |
| DESIGN-REVIEWED | | | | | |
| REVISIONS 1 | | | | | |
| REVISIONS 2 | | | | | |
| REVISIONS 3 | | | | | |
| REVISIONS 4 | | | | | |
| FIELD CHANGES | | | | | |

BIDDEFORD
ALFRED STREET (ROUTE 111)
ALTERNATIVE 1

SHEET NUMBER
2
OF 2

SHADING LEGEND

- 2" MILL AND OVERLAY
- PROPOSED 4.0" REINFORCED CONCRETE SIDEWALK
- PROPOSED GREEN SURFACE TREATMENT

STRIPING LEGEND

- SWL SOLID WHITE LINE (4")
- 2SYL TWO SOLID YELLOW LINES (4")
- DWL DOTTED WHITE LINE (4")
- WCH WHITE CROSS HATCHING (12")
- STOP BAR STOP BAR (24")

SIGN LEGEND

- R10-6a
24" X 30"
NEW
- R10-11
24" X 30"
NEW
- R3-17
24" X 18"
NEW
- R3-17aP
24" X 9"
NEW
- R3-17bP
24" X 9"
NEW
- R3-7bP
24" X 12"
NEW

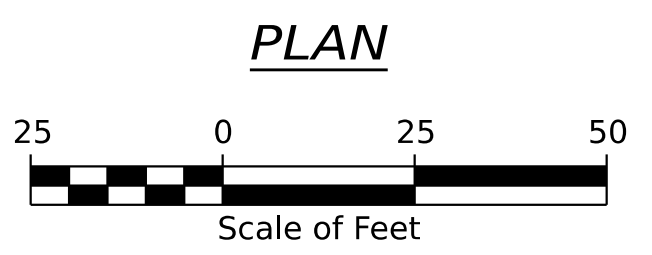
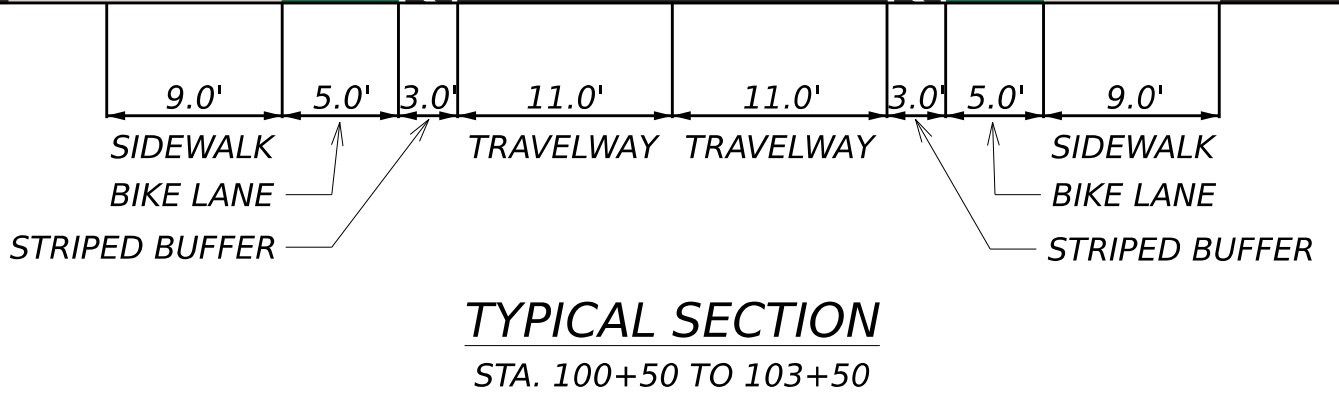
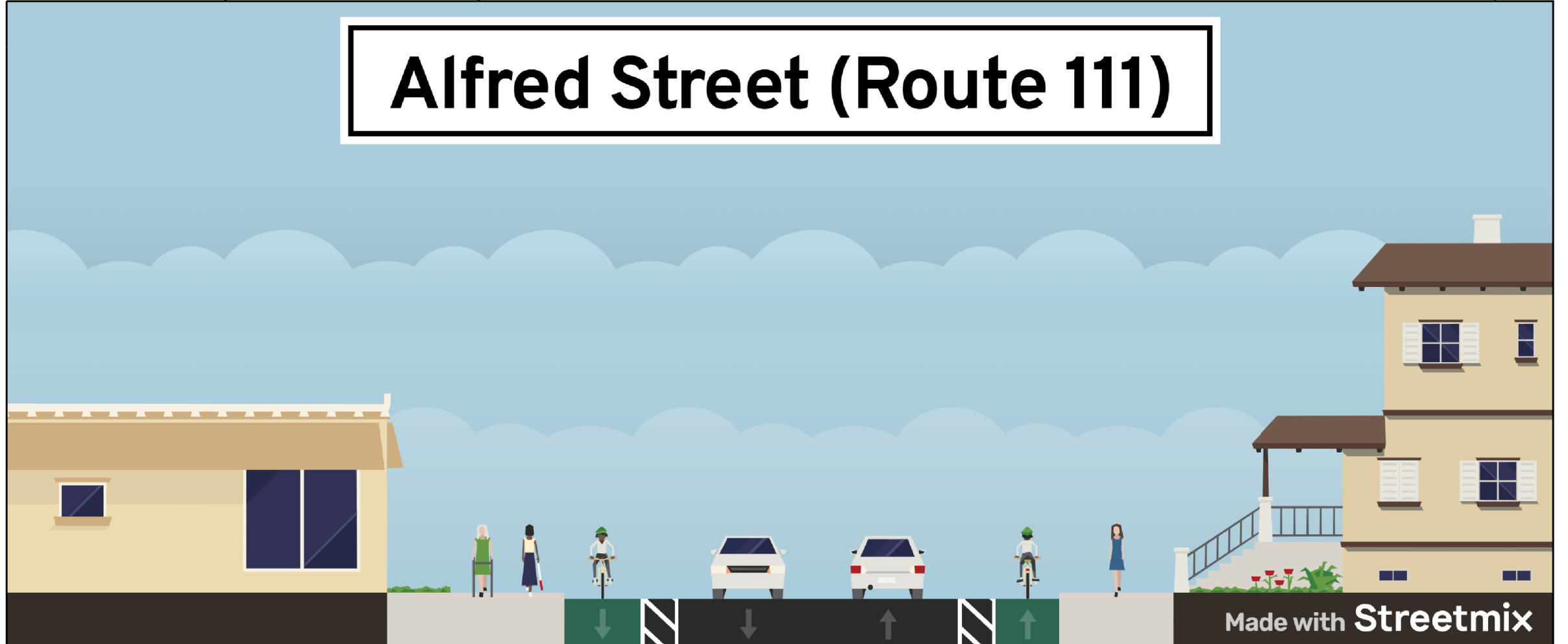
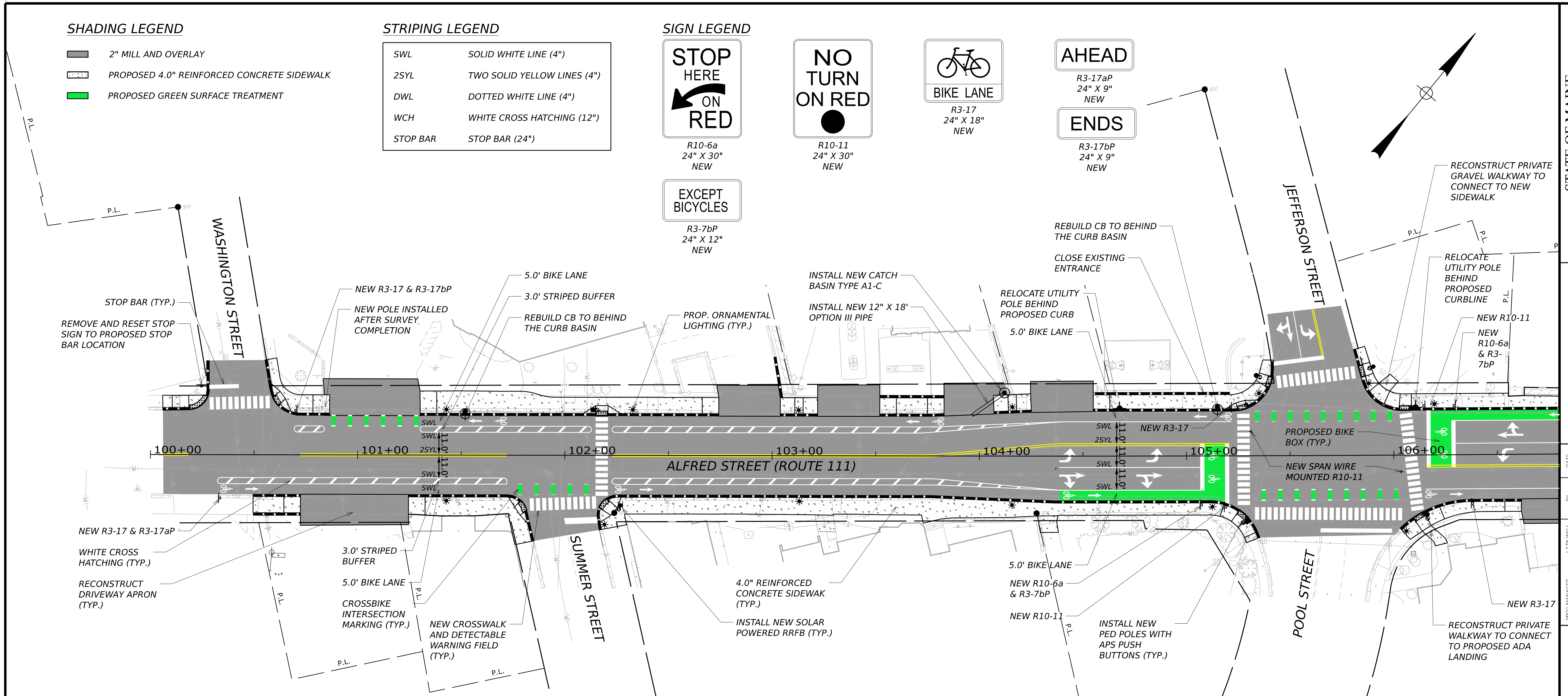

STATE OF MAINE
DEPARTMENT OF TRANSPORTATION
28488.00
WIN
28488.00
HIGHWAY PLANS

| DATE | BY | REVISION |
|----------|-------------|------------------|
| 06/17/26 | J. STILWELL | PROJ. MANAGER |
| 06/17/26 | Z. JACKSON | DESIGN-REVIEWED |
| 06/17/26 | B. LYON | CHECKED-REVIEWED |
| | | DESIGN-DETAILED |
| | | DESIGN-DETAILED |
| | | REVISIONS 1 |
| | | REVISIONS 2 |
| | | REVISIONS 3 |
| | | REVISIONS 4 |
| | | FIELD CHANGES |

**BIDDEFORD
ALFRED STREET (ROUTE 111)
ALTERNATIVE 2**

**SHEET NUMBER
1
OF 2**

Username: Date: 6/18/2026

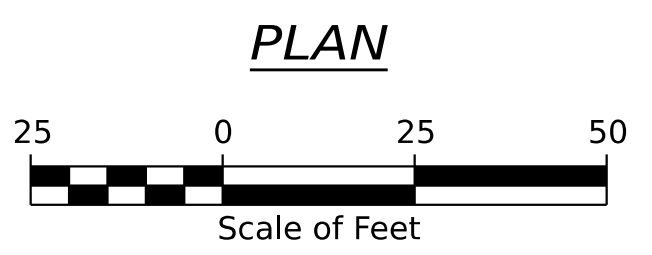
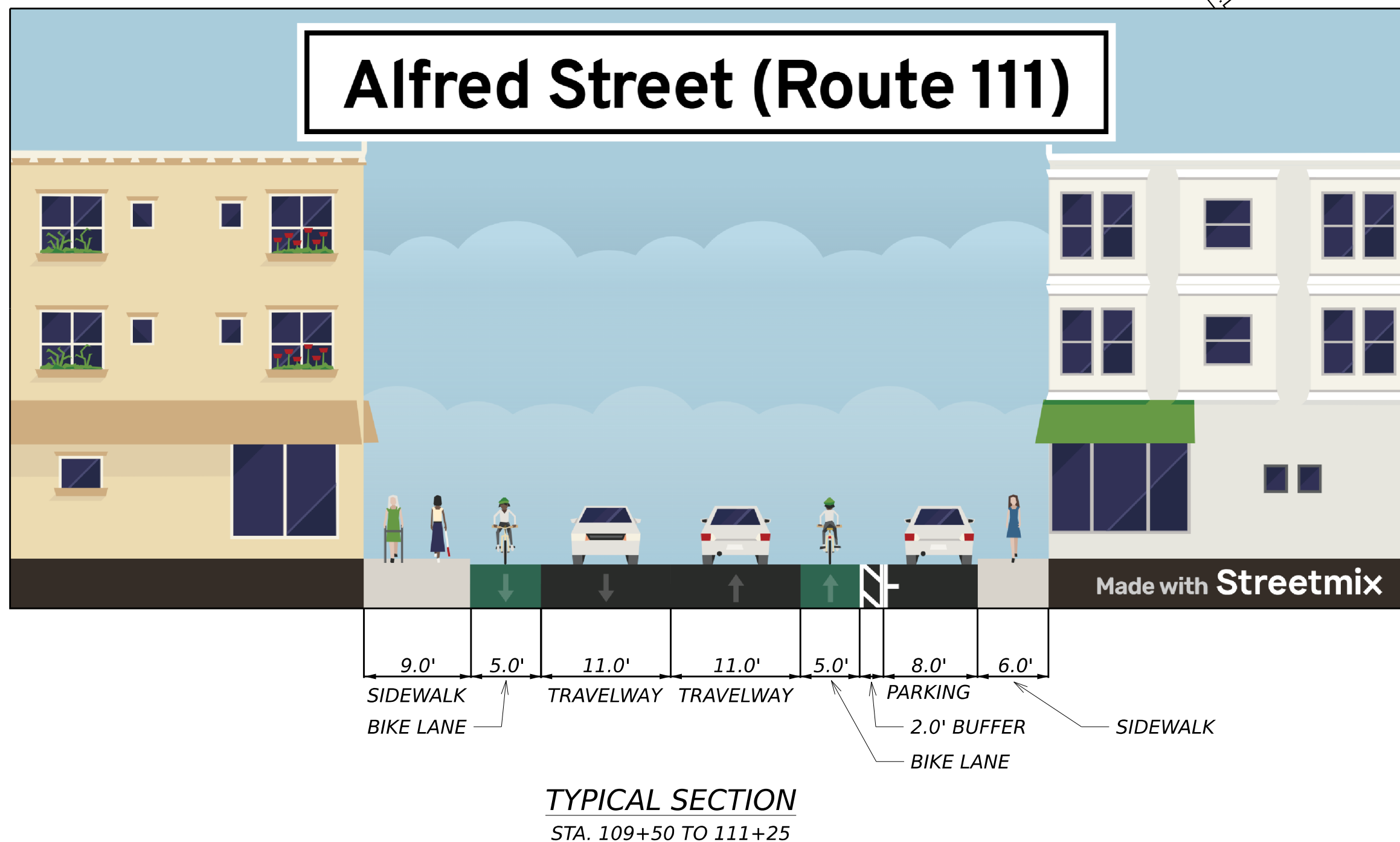
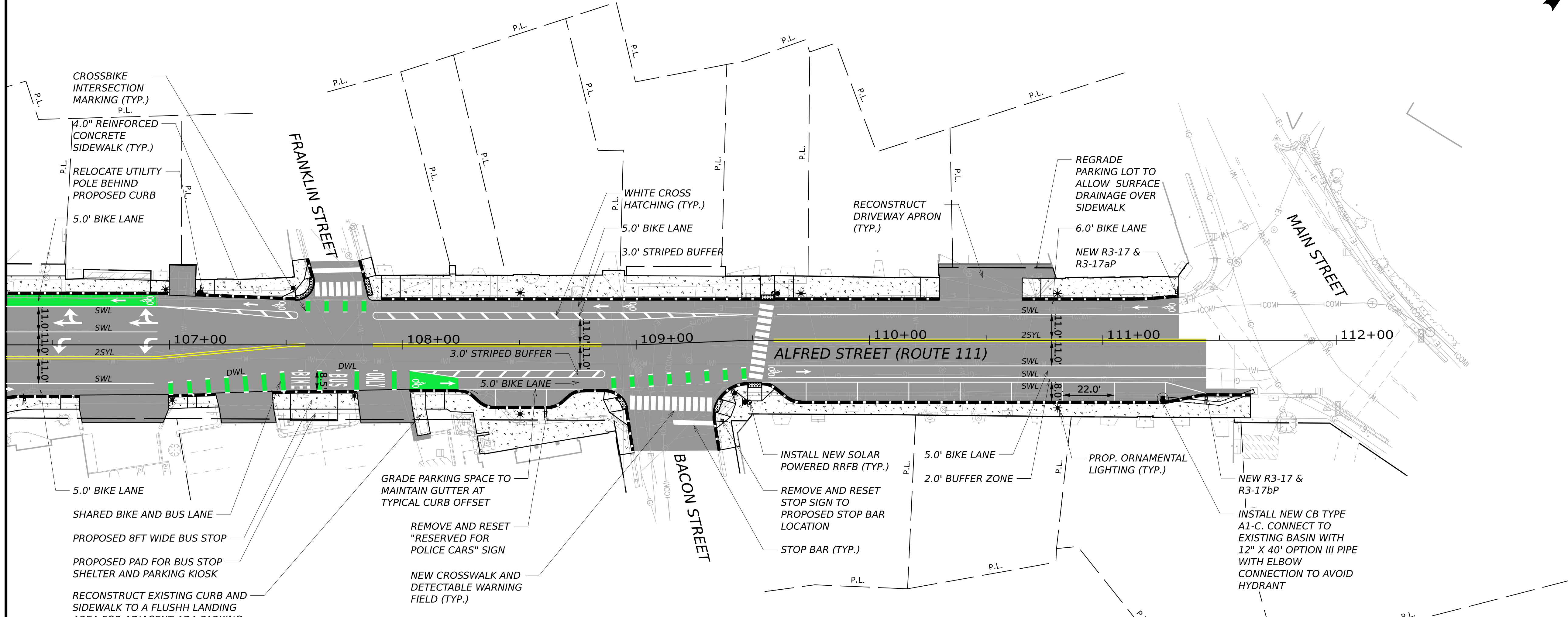
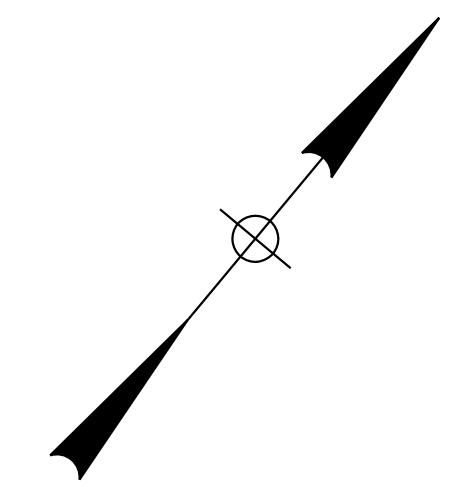

STATE OF MAINE
DEPARTMENT OF TRANSPORTATION

28488-00

WIN
28488-00

HIGHWAY PLANS

| PROJ. MANAGER | DATE | BY | DATE | SIGNATURE | P.E. NUMBER | DATE |
|-------------------|----------|------------|----------|-----------|-------------|------|
| J. STILWELL | 06/17/26 | Z. JACKSON | 06/17/26 | | | |
| DESIGN-DETAILED | | B. LYON | | | | |
| CHECKED-REVIEWED | | | | | | |
| DESIGN-DETAILED02 | | | | | | |
| DESIGN-DETAILED03 | | | | | | |
| REVISIONS 1 | | | | | | |
| REVISIONS 2 | | | | | | |
| REVISIONS 3 | | | | | | |
| REVISIONS 4 | | | | | | |
| FIELD CHANGES | | | | | | |

BIDDEFORD
ALFRED STREET (ROUTE 111)
ALTERNATIVE 2

SHEET NUMBER
2
OF 2

Username: Date: 6/18/2026

| SECTION | ITEM | EXISTING | ALTERNATIVE #1 | ALTERNATIVE #2 |
|---|------------------------------------|-----------------------|---------------------------|---------------------------|
| Washington St. to Pool St./Jefferson St. | Curb to Curb Width (Roadway Width) | 40' | 28'-40' | 40'-43' |
| | Sidewalk Width | 7'-9' | 8'-9' | 8'-12' |
| | Sidewalks ADA/PROWAG Compliant? | No | Yes | Yes |
| | Green Space Provided | No | Yes | No |
| | Dedicated Bicycle Facilities? | No | No | Yes |
| | # of Crosswalks | 4 | 3 | 3 |
| | Crosswalk Width | 40'-60' | 28'-50' | 40'-50' |
| | # of On-Street Parking Spaces | 2 | 1 | 0 |
| | Street Lighting | Minimal (Cobra Heads) | Yes (Ornamental Lighting) | Yes (Ornamental Lighting) |
| Pool St./Jefferson St. to Main St. | Curb to Curb Width (Roadway Width) | 40' | 38'-40' | 38'-43' |
| | Sidewalk Width | 8'-11' | 8'-11' | 6'-11' |
| | Sidewalks ADA/PROWAG Compliant? | No | Yes | Yes |
| | Green Space Provided | No | No | No |
| | Dedicated Bicycle Facilities? | No | No | Yes |
| | # of Crosswalks | 4 | 3 | 3 |
| | Crosswalk Width | 45'-60' | 35'-50' | 35'-50' |
| | # of On-Street Parking Spaces | 25 +/- | 12 | 7 |
| | Street Lighting | Minimal (Cobra Heads) | Yes (Ornamental Lighting) | Yes (Ornamental Lighting) |
| Estimated Construction Cost | | N/A | \$1,970,000.00 | \$1,993,000.00 |
| Estimated Mill and Overlay Cost (Paid by City of Biddeford) | | N/A | \$542,425.00 | \$575,325.00 |

**Alfred Street Improvements
Alternative #1 Estimate**

| ITEM NO. | ITEM DESCRIPTION | UNIT | AVERAGE UNIT COST | QUANTITY | COST |
|-----------------------------------|---|------|-------------------|----------|------------------------|
| 203.2001 | COMMON EXCAVATION (PLAN QUANTITY) | CY | \$50.00 | 50 | \$ 2,500.00 |
| 206.07 | STRUCTURAL ROCK EXCAVATION - DRAINAGE & MINOR STRUCTURES | CY | \$200.00 | 10 | \$ 2,000.00 |
| 403.209 | HMA PAVEMENT 9.5 MM (SIDEWALKS, DRIVES, ETC.) | TONS | \$300.00 | 95 | \$ 28,500.00 |
| 403.150 | BITUMINOUS TACK COAT | GAL | \$40.00 | 20 | \$ 800.00 |
| 603.159 | 12" CULVERT PIPE OPTION III | LF | \$110.00 | 18 | \$ 1,980.00 |
| 604.072 | CATCH BASIN TYPE A1-C | EA | \$6,000.00 | 1 | \$ 6,000.00 |
| 604.164 | REBUILDING CATCH BASIN | EA | \$1,500.00 | 1 | \$ 1,500.00 |
| 608.08 | REINFORCED CONCRETE SIDEWALK | SY | \$200.00 | 1950 | \$ 390,000.00 |
| 608.26 | CURB RAMP DETECTABLE WARNING FIELD | SF | \$120.00 | 220 | \$ 26,400.00 |
| 609.11 | VERTICAL CURB TYPE 1 | LF | \$75.00 | 1920 | \$ 144,000.00 |
| 615.0701 | LOAM (PLAN QUANTITY) | CY | \$75.00 | 25 | \$ 1,875.00 |
| 618.13 | SEEDING METHOD NUMBER 1 | EA | \$75.00 | 2 | \$ 150.00 |
| 619.1201 | MULCH (PLAN QUANTITY) | EA | \$75.00 | 2 | \$ 150.00 |
| 626.11 | PRECAST CONCRETE JUNCTION BOX | EA | \$1,500.00 | 30 | \$ 45,000.00 |
| 626.21 | METALLIC CONDUIT | LF | \$125.00 | 100 | \$ 12,500.00 |
| 626.22 | NON-METALLIC CONDUIT | LF | \$100.00 | 2350 | \$ 235,000.00 |
| 626.3211 | 20" DIAMETER FOUNDATION | LF | \$325.00 | 168 | \$ 54,600.00 |
| 626.4210 | 24" DIAMETER FOUNDATION | LF | \$350.00 | 63 | \$ 22,050.00 |
| 627.7330 | 4" WHITE OR YELLOW PAVEMENT AND CURB MARKING | LF | \$1.00 | 2750 | \$ 2,750.00 |
| 627.75 | WHITE OR YELLOW PAVEMENT AND CURB MARKING | SF | \$3.00 | 2280 | \$ 6,840.00 |
| 629.05 | HAND LABOR STRAIGHT TIME | HR | \$55.00 | 10 | \$ 550.00 |
| 631.12 | ALL PURPOSE EXCAVATOR (INCLUDING OPERATOR) | HR | \$175.00 | 10 | \$ 1,750.00 |
| 631.172 | TRUCK LARGE (INCLUDING OPERATOR) | HR | \$150.00 | 10 | \$ 1,500.00 |
| 634.21 | CONVENTIONAL LIGHT STANDARD | EA | \$7,500.00 | 24 | \$ 180,000.00 |
| 643.620 | RECTANGULAR RAPID FLASHING BEACON (PAIR) | EA | \$20,000.00 | 2 | \$ 40,000.00 |
| 643.710 | TRAFFIC SIGNAL MODIFICATION: ALFRED ST. AT POOL ST. | LS | \$12,000.00 | 1 | \$ 12,000.00 |
| 643.920 | PEDESTAL POLE | EA | \$2,000.00 | 5 | \$ 10,000.00 |
| 645.106 | DEMOUNT REGULATORY, WARNING, CONFIRMATION & ROUTE ASSEMBLY SIGN | EA | \$300.00 | 3 | \$ 900.00 |
| 645.116 | REINSTALL REGULATORY, WARNING, CONFIRMATION & ROUTE ASSEMBLY SIGN | EA | \$300.00 | 3 | \$ 900.00 |
| 652.39 | WORK ZONE TRAFFIC CONTROL | LS | \$250,000.00 | 1 | \$ 250,000.00 |
| 656.75 | TEMPORARY SOIL EROSION AND WATER POLLUTION CONTROL | LS | \$10,000.00 | 1 | \$ 10,000.00 |
| 659.10 | MOBILIZATION (10%) | LS | \$149,219.50 | 1 | \$ 149,219.50 |
| SUBTOTAL | | | | | \$ 1,641,414.50 |
| CONTINGENCY (20%) | | | | | \$ 328,282.90 |
| 2026 CONSTRUCTION SUBTOTAL | | | | | \$ 1,969,697.40 |

**Alfred Street Sidewalk Improvements (Mill and Overlay Paid by City of Biddeford)
Conceptual Estimate**

| ITEM NO. | ITEM DESCRIPTION | UNIT | AVERAGE UNIT COST | QUANTITY | COST |
|-----------------------------------|-------------------------------------|------|-------------------|----------|----------------------|
| 202.202 | REMOVING PAVEMENT SURFACE | SY | \$25.00 | 5500 | \$ 137,500.00 |
| 403.208 | HOT MIX ASPHALT 12.5 MM HMA SURFACE | TONS | \$325.00 | 1225 | \$ 398,125.00 |
| 409.150 | BITUMINOUS TACK COAT | GAL | \$40.00 | 170 | \$ 6,800.00 |
| SUBTOTAL | | | | | \$ 542,425.00 |
| 2026 CONSTRUCTION SUBTOTAL | | | | | \$ 542,425.00 |

**Alfred Street Improvements
Alternative #2 Estimate**

| ITEM NO. | ITEM DESCRIPTION | UNIT | AVERAGE UNIT COST | QUANTITY | COST |
|-----------------------------------|---|------|-------------------|----------|------------------------|
| 203.20 | COMMON EXCAVATION (PLAN QUANTITY) | CY | \$50.00 | 125 | \$ 6,250.00 |
| 206.07 | STRUCTURAL ROCK EXCAVATION - DRAINAGE & MINOR STRUCTURES | CY | \$200.00 | 10 | \$ 2,000.00 |
| 304.10 | AGGREGATE SUBBASE COURSE - GRAVEL | CY | \$75.00 | 75 | \$ 5,625.00 |
| 403.209 | HMA PAVEMENT 9.5 MM (SIDEWALKS, DRIVES, ETC.) | TONS | \$300.00 | 100 | \$ 30,000.00 |
| 409.150 | BITUMINOUS TACK COAT | GAL | \$40.00 | 20 | \$ 800.00 |
| 603.159 | 12" CULVERT PIPE OPTION III | LF | \$110.00 | 58 | \$ 6,380.00 |
| 604.072 | CATCH BASIN TYPE A1-C | EA | \$6,000.00 | 2 | \$ 12,000.00 |
| 604.164 | REBUILDING CATCH BASIN | EA | \$1,500.00 | 2 | \$ 3,000.00 |
| 608.08 | REINFORCED CONCRETE SIDEWALK | SY | \$200.00 | 1875 | \$ 375,000.00 |
| 608.26 | CURB RAMP DETECTABLE WARNING FIELD | SF | \$120.00 | 220 | \$ 26,400.00 |
| 609.11 | VERTICAL CURB TYPE 1 | LF | \$75.00 | 1880 | \$ 141,000.00 |
| 626.11 | PRECAST CONCRETE JUNCTION BOX | EA | \$1,500.00 | 30 | \$ 45,000.00 |
| 626.21 | METALLIC CONDUIT | LF | \$125.00 | 100 | \$ 12,500.00 |
| 626.22 | NON-METALLIC CONDUIT | LF | \$100.00 | 2350 | \$ 235,000.00 |
| 626.3211 | 20" DIAMETER FOUNDATION | LF | \$325.00 | 168 | \$ 54,600.00 |
| 626.4210 | 24" DIAMETER FOUNDATION | LF | \$350.00 | 63 | \$ 22,050.00 |
| 627.7330 | 4" WHITE OR YELLOW PAVEMENT AND CURB MARKING | LF | \$1.00 | 4250 | \$ 4,250.00 |
| 627.75 | WHITE OR YELLOW PAVEMENT AND CURB MARKING | SF | \$3.00 | 4900 | \$ 14,700.00 |
| 629.05 | HAND LABOR STRAIGHT TIME | HR | \$55.00 | 10 | \$ 550.00 |
| 631.12 | ALL PURPOSE EXCAVATOR (INCLUDING OPERATOR) | HR | \$175.00 | 10 | \$ 1,750.00 |
| 631.172 | TRUCK LARGE (INCLUDING OPERATOR) | HR | \$150.00 | 10 | \$ 1,500.00 |
| 634.21 | CONVENTIONAL LIGHT STANDARD | EA | \$7,500.00 | 24 | \$ 180,000.00 |
| 643.620 | RECTANGULAR RAPID FLASHING BEACON (PAIR) | EA | \$20,000.00 | 2 | \$ 40,000.00 |
| 643.710 | TRAFFIC SIGNAL MODIFICATION: ALFRED ST. AT POOL ST. | LS | \$13,000.00 | 1 | \$ 13,000.00 |
| 643.920 | PEDESTAL POLE | EA | \$2,000.00 | 5 | \$ 10,000.00 |
| 645.106 | DEMOUNT REGULATORY, WARNING, CONFIRMATION & ROUTE ASSEMBLY SIGN | EA | \$300.00 | 3 | \$ 900.00 |
| 645.116 | REINSTALL REGULATORY, WARNING, CONFIRMATION & ROUTE ASSEMBLY SIGN | EA | \$300.00 | 3 | \$ 900.00 |
| 645.271 | REGULATORY, WARNING, CONFIRMATION & ROUTE SIGN | SF | \$90.00 | 50 | \$ 4,500.00 |
| 652.39 | WORK ZONE TRAFFIC CONTROL | LS | \$250,000.00 | 1 | \$ 250,000.00 |
| 656.75 | TEMPORARY SOIL EROSION AND WATER POLLUTION CONTROL | LS | \$10,000.00 | 1 | \$ 10,000.00 |
| 659.10 | MOBILIZATION (10%) | LS | \$150,965.50 | 1 | \$ 150,965.50 |
| SUBTOTAL | | | | | \$ 1,660,620.50 |
| CONTINGENCY (20%) | | | | | \$ 332,124.10 |
| 2026 CONSTRUCTION SUBTOTAL | | | | | \$ 1,992,744.60 |

**Alfred Street Sidewalk Improvements (Mill and Overlay Paid by City of Biddeford)
Conceptual Estimate**

| ITEM NO. | ITEM DESCRIPTION | UNIT | AVERAGE UNIT COST | QUANTITY | COST |
|-----------------------------------|-------------------------------------|------|-------------------|----------|----------------------|
| 202.202 | REMOVING PAVEMENT SURFACE | SY | \$25.00 | 5825 | \$ 145,625.00 |
| 403.208 | HOT MIX ASPHALT 12.5 MM HMA SURFACE | TONS | \$325.00 | 1300 | \$ 422,500.00 |
| 409.150 | BITUMINOUS TACK COAT | GAL | \$40.00 | 180 | \$ 7,200.00 |
| SUBTOTAL | | | | | \$ 575,325.00 |
| 2026 CONSTRUCTION SUBTOTAL | | | | | \$ 575,325.00 |

